

DYMH-102 Flat membrane box load cell

Features and uses:

The sensor uses flat diaphragm pressure, shell and diaphragm integrated structure, small size, stable and reliable performance.

Applicable to a variety of load weighing industrial automation measurement and control system.

We have capacity range: 50kg, 100kg, 200kg, 500kg, 1t, 2t, 3t, 5t.



Size:

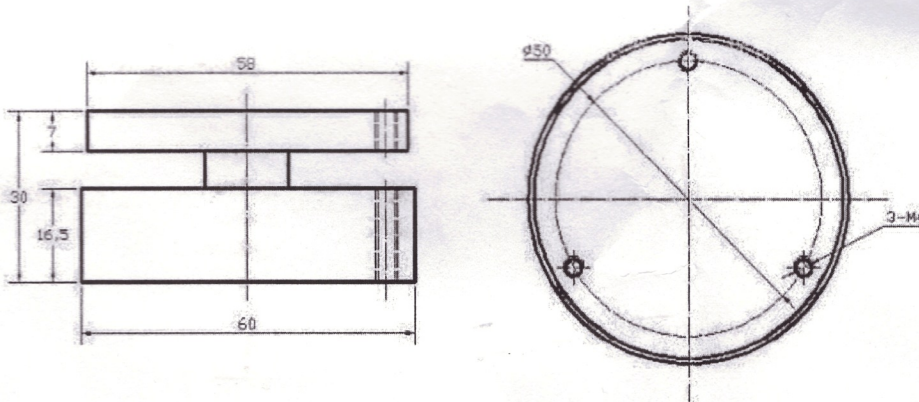

Technical Specifications:

Parameter	Unit	Technical Specifications	Parameter	Unit	Technical Specifications
Sensitivity	mV/V	1-2±0.05	Temperature coefficient of sensitivity	≤%F·S/10℃	±0.1
Nonlinear	≤%F·S	±0.3	Operating temperature range	℃	-20℃~+80℃
Hysteresis	≤%F·S	±0.3	Input resistance	Ω	700Ω
Repeatability	≤%F·S	±0.3	Output Resistance	Ω	700Ω
Creep	≤%F·S/30min	±0.1	Safe Overload	≤%F·S	150% F·S
Zero output	≤%F·S	±1	Insulation resistance	MΩ	≥5000MΩ/100VDC
Zero temperature coefficient	≤%F·S/10℃	±0.1	Excitation voltage	V	10V-15V

Wiring: Input: Red (+) Black (-) Output: Green (+) White (-)